

INSTALLATION MANUAL (EN)

LED-LAMP (7030/7050)

SVEDBERGS®

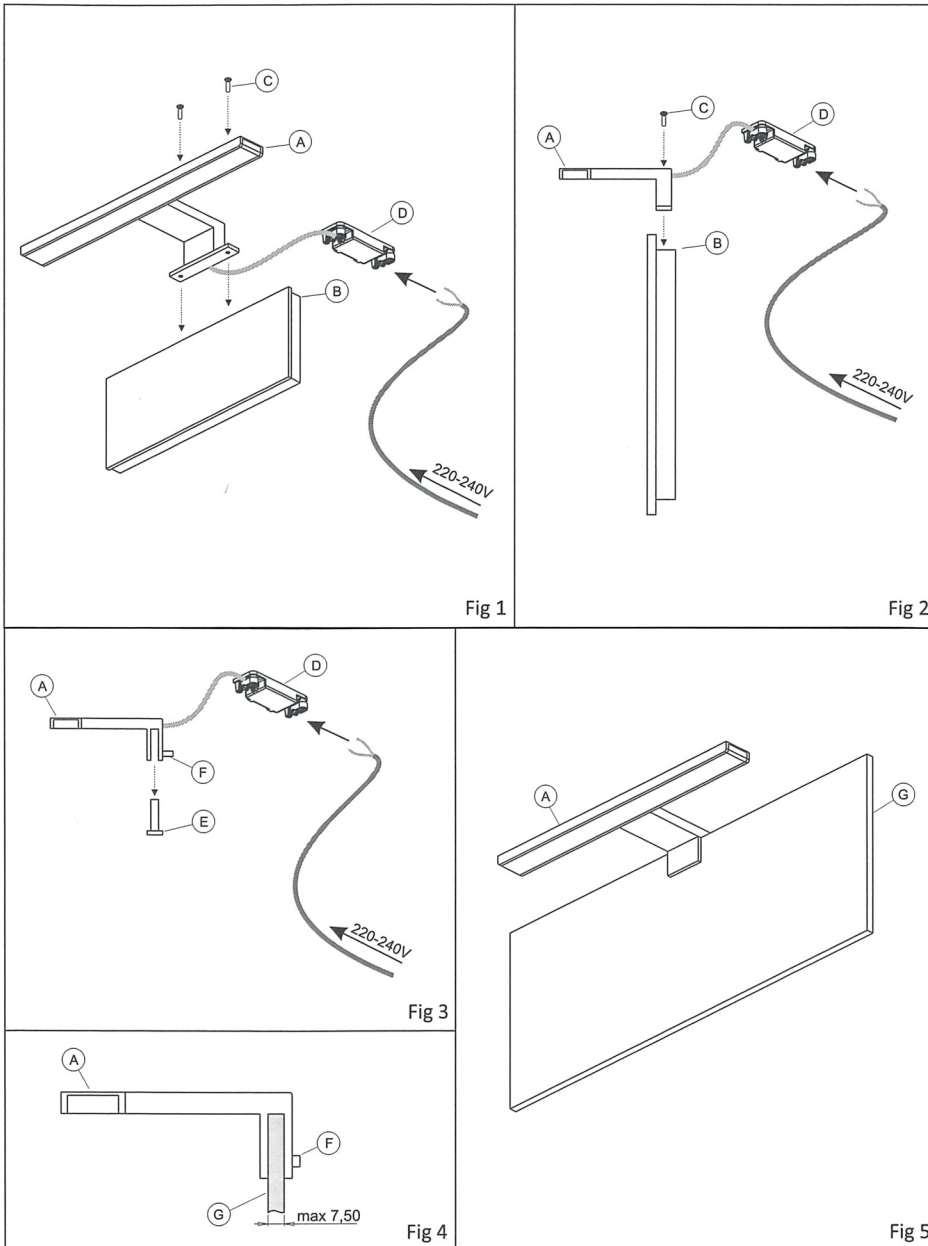

WARNING:

Safety is guaranteed if these instructions are followed and therefore they must be kept. Installation may require qualified personnel to be involved. Before proceeding with installation of the device ensure that the environmental conditions are in compliance with and suitable for the product characteristics. Before carrying out any operation on the device remove mains power.

SHELF INSTALLATION (fig. 1,2):

- Secure the light (A) to the shelf (B) using the provided screws (C).

INSTALLATION ON MIRROR (Fig. 3,4,5):

- Remove the support bracket (E) loosening the grub screws (F) (Fig. 3).
- Insert the light (A) onto the mirror (G) ensuring that it is not thicker than 7.5mm (Fig. 4).
- Secure the light (A) to the mirror (G) using the grub screws (F) (Fig. 4,5).

ELECTRICAL CONNECTION:

- Remove power from the mains.
- Connection of the power supply cable to the 230V mains must be carried out using the junction box (D) that is provided in the package.
- The power supply cable must not be accessible after installation of the device.

- If the provided connector terminal is not used, used connection devices certified in compliance with the EN 60998 standard.
- House this device in an adequately sized box.

WHC VERSION OPERATION (changes colour):

AALTO / LEVEL WHC has a light source with 3 selectable colour temperatures (3000-4000-6000K). To make this selection proceed as follows:
Switch AALTO / LEVEL WHC on and then switch off within 10 second and then switch back on. Each time it is switched on a different colour temperature will be selected.
To store the selected tone, leave the light on for more than 10-seconds.

WARNING

- The LED module for these devices cannot be replaced and therefore in the event of failure the entire device must be completely replaced.
- Do not use the device if the power cable and/or the connection cables are defective. Defective cables and/or connectors must be immediately replaced by qualified personnel authorised by DOMUS Line.
- Never run any cable through sharp corners and edges.
- Never run the cable over hot parts and always protect it against contact with liquids.
- Install the device in a position that is out of the reach of children.

- If the cable needs to be secured use only insulated clips or plastic cable ties.
- Ensure that the cable is not crushed between the wall and the mirror.
- Never use extension cables that are not compatible with the original connection system.
- Before cleaning the device ensure that you have switched it off and wait until it has cooled.
- Never immerse the device in water.
- To clean the metallic parts of the device use a soft and dry cloth and never, under any circumstances, use liquid detergents, abrasive products or similar items that could irreparably scratch and damage the surface.
- For stubborn dirt a cloth slightly dampened with water may be used. In this case, never bring the cloth into contact with the live electrical parts (cables, connectors, etc.) and after cleaning, dry the device very well and ensure that no residual dampness remains.

WARRANTY

- The warranty on the device is valid only if powered by a power supply provided by DOMUS Line. The warranty's general terms and conditions for this device are available at www.domusline.com